

## Level 13

## 5-1000MHz Frequency Mixer

### Features

- LO/RF: 5-1000MHz
- IF: DC-1000MHz
- LO Level: +13dBm
- Conversion Loss: 7.0dB
- RF Input: Up to +9dBm
- IP3: +22dBm
- SMA Connector

### Picture

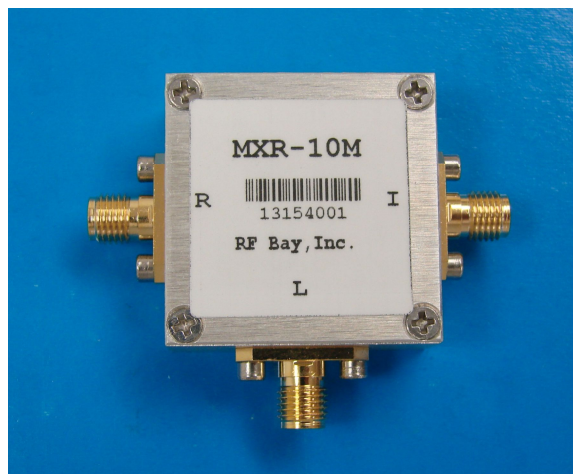

### Description

MXR-10M is a passive double balanced mixer operates with LO drive level range of +10dBm to +16dBm.

### Electrical Specifications @ +25 °C, LO= +13dBm, IF=30MHz, 50Ω

Parameter	Unit	Minimum	Typical	Maximum
Frequency Range				
LO/RF	MHz	5		1000
IF	MHz	DC		1000
Conversion Loss	dB		7.0	9.5
LO-RF Isolation				
5-50 MHz	dB	40	55	
50-500MHz	dB	20	39	
500-1000MHz	dB	16	22	
LO-IF Isolation				
5-50MHz	dB	35	52	
50-500MHz	dB	27	30	
500-1000MHz	dB	12	18	
RF Input Power up to	dBm		+9	
Input IP3 (Center Band)	dBm		+22	

Unless otherwise noted, all measurements performed as a downconverter.

## Level 13

## 5-1000MHz Frequency Mixer

### Typical Performance @ +25 °C

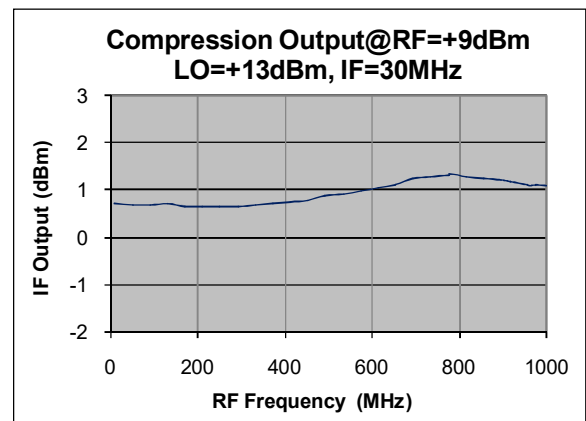
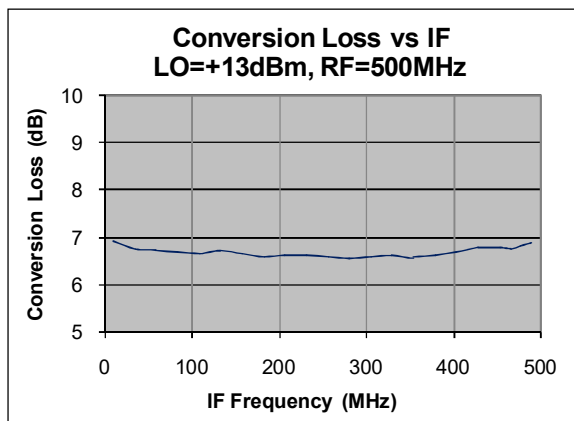
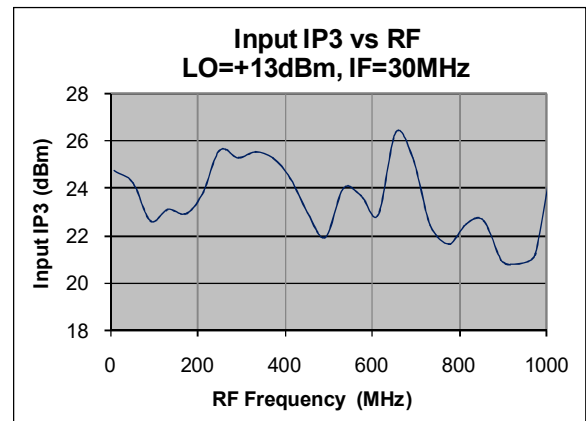
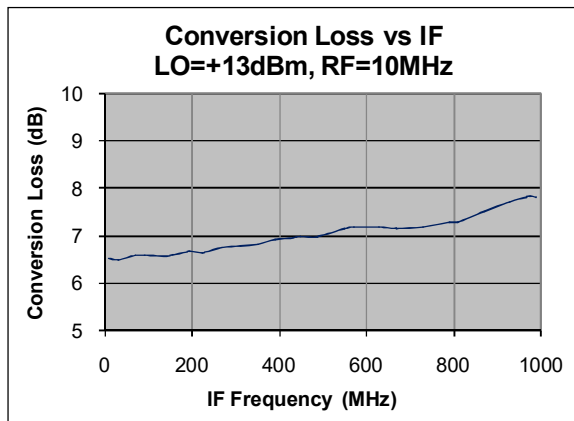
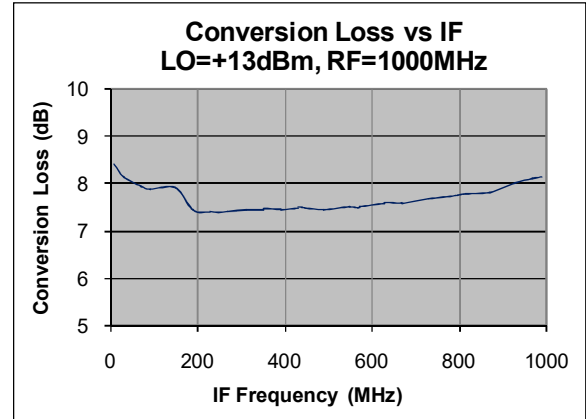
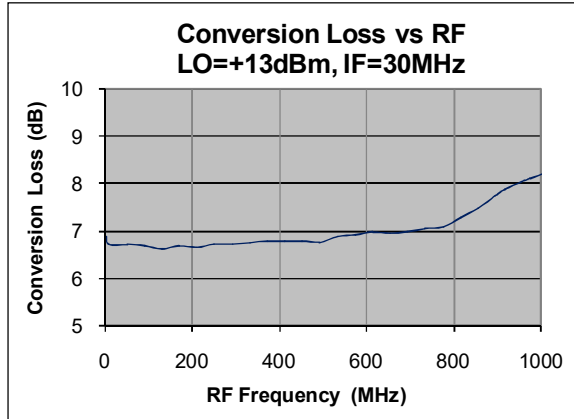

## Level 13

## 5-1000MHz Frequency Mixer

### Typical Performance @ +25 °C

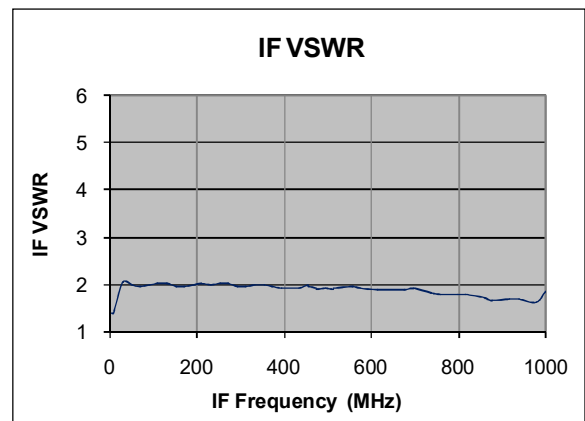
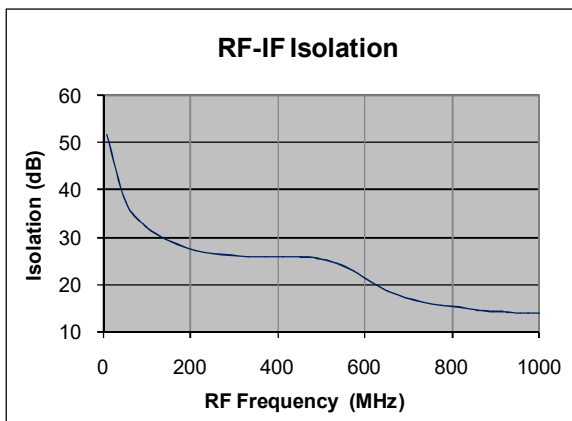
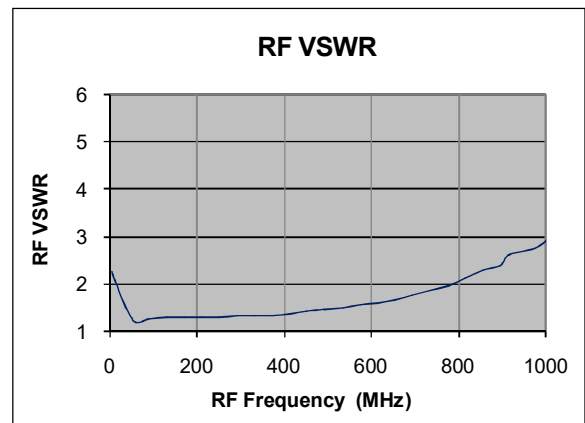
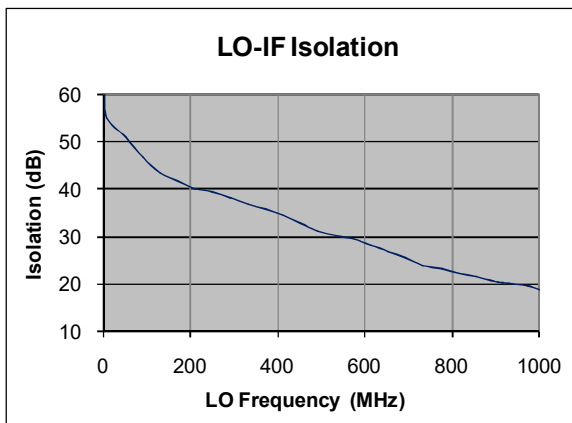
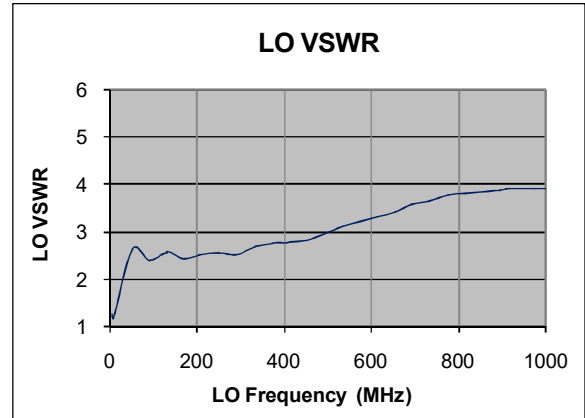
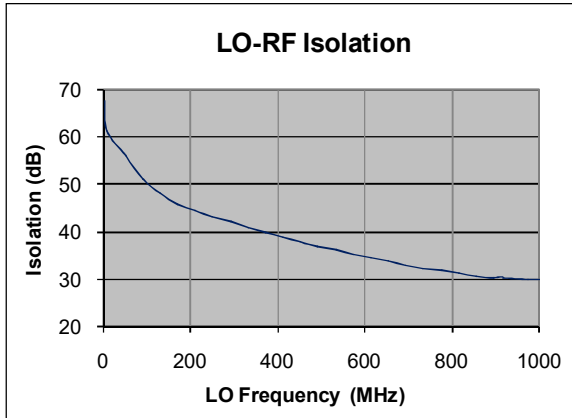

## Level 13

## 5-1000MHz Frequency Mixer

### Absolute Maximum Ratings

Parameter	Absolute Maximum
RF Power	+23dBm
Peak IF Current	40mA
Operating Temperature	-40 °C to +85 °C
Storage Temperature	-55 °C to +100 °C

### Schematic

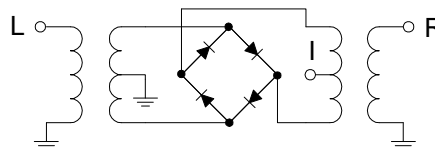

### Outline

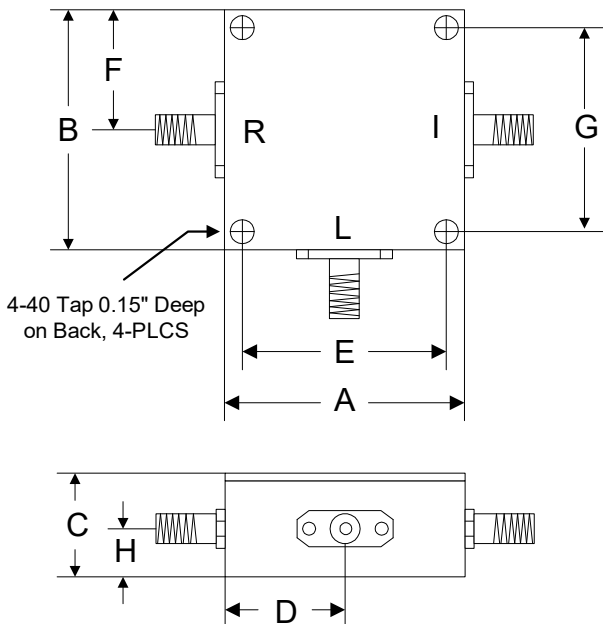

	A	B	C	D	E	F	G	H
<b>Inch</b>	1.250	1.250	0.563	0.625	1.000	0.625	1.000	0.250
<b>mm</b>	31.75	31.75	14.29	15.88	25.40	15.88	25.40	6.35