

**Level 13**

**800-4200MHz Frequency Mixer**

**Features**

- LO/RF: 800-4200MHz
- IF: DC-800MHz
- LO Level: +13dBm
- Conversion Loss: 9dB
- RF Input: Up to +9dBm
- IP3: +19dBm
- SMA Connector

**Picture**

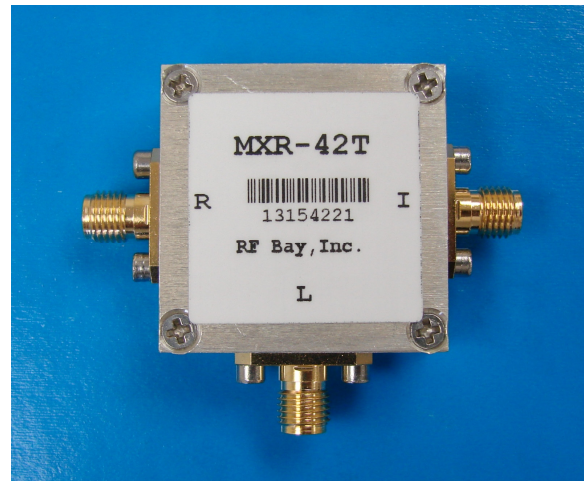

**Description**

MXR-42T is a passive double balanced mixer operates with LO drive level range of +10dBm to +16dBm.

**Electrical Specifications @ +25 °C, LO= +13dBm**

Parameter	Unit	Minimum	Typical	Maximum
Frequency Range				
LO/RF	MHz	800		4200
IF	MHz	DC		800
Conversion Loss	dB		9.0	10.8
LO-RF Isolation				
800-2100MHz	dB	25	35	
2100-4200MHz	dB	17	28	
LO-IF Isolation				
800-2100MHz	dB	10	18	
2100-4200MHz	dB	7	15	
RF Input Power up to	dBm		+9	
Input IP3 (Center Band)	dBm		+19	

**Level 13**

**800-4200MHz Frequency Mixer**

**Typical Performance @ +25 °C**

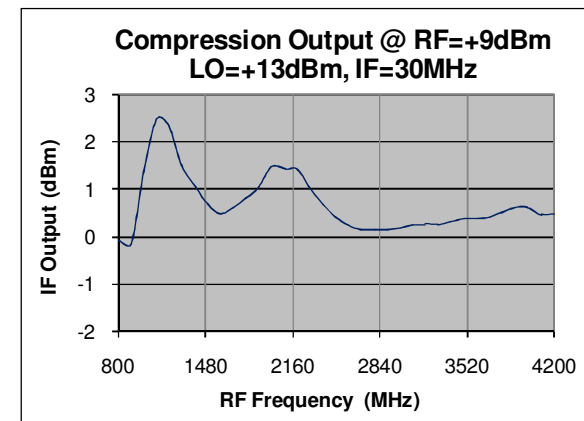
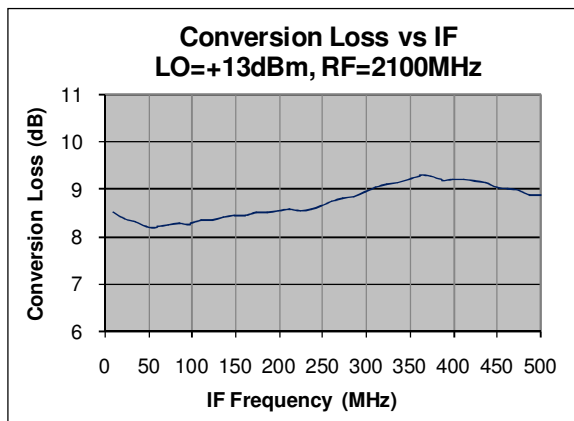
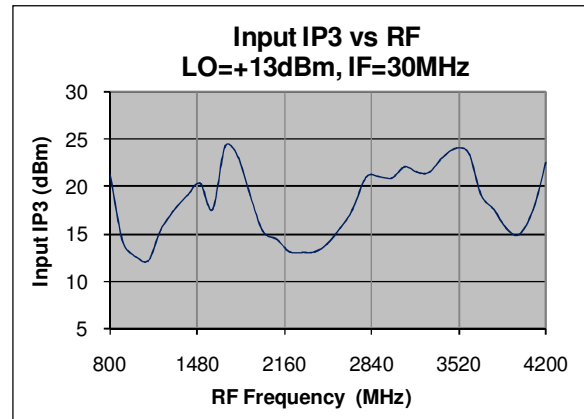
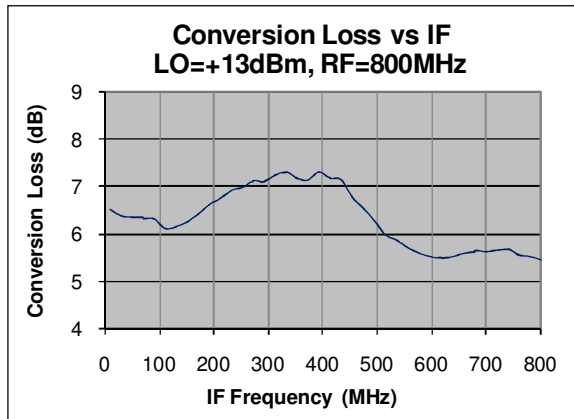
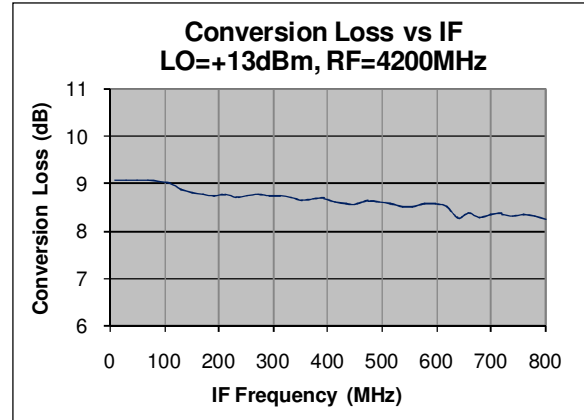
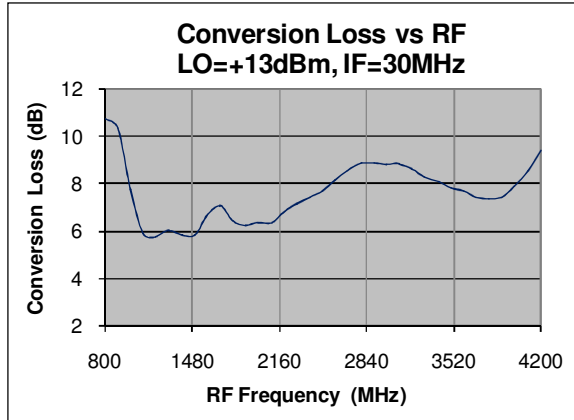

**Level 13**

**800-4200MHz Frequency Mixer**

**Typical Performance @ +25 °C**

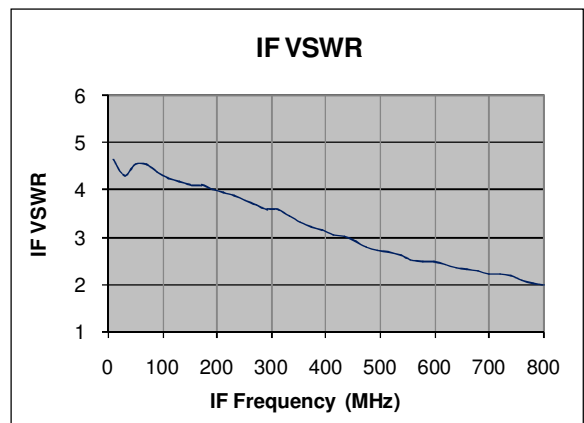
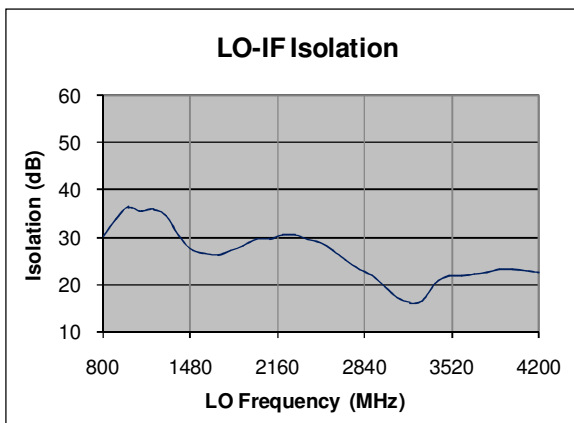
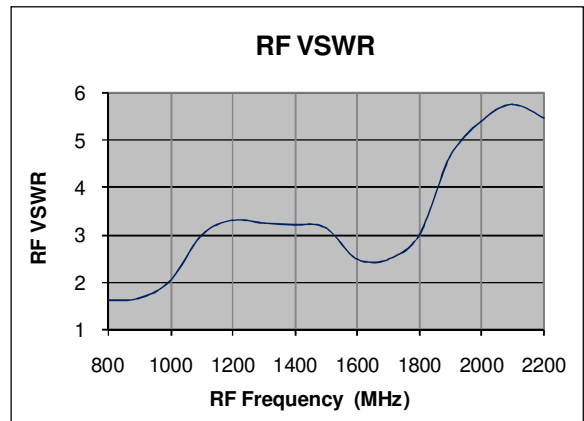
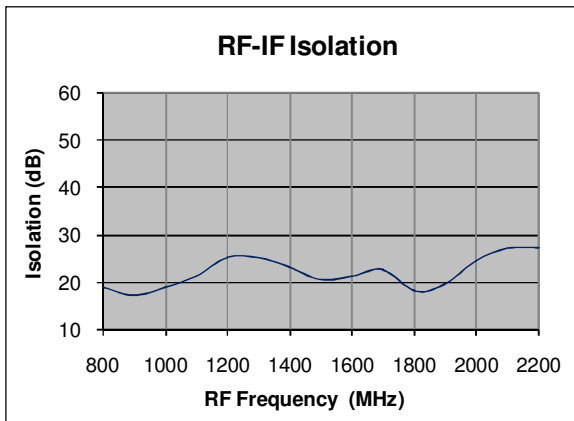
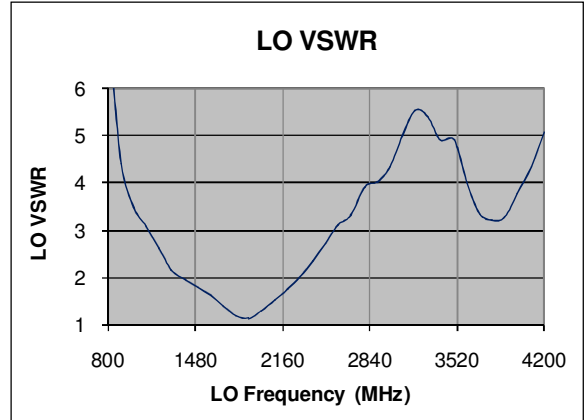
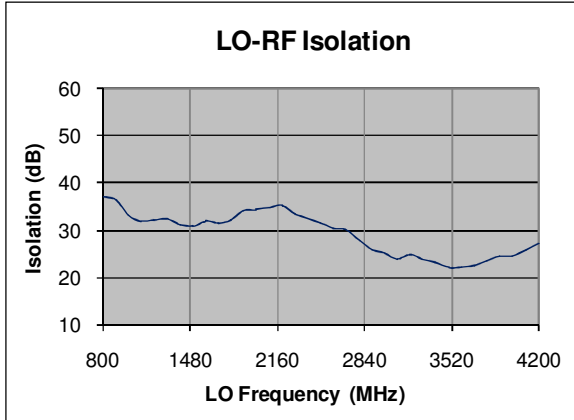

**Level 13**

**800-4200MHz Frequency Mixer**

**Absolute Maximum Ratings**

Parameter	Absolute Maximum
RF Power	+23dBm
Peak IF Current	40mA
Operating Temperature	-40 °C to +85 °C
Storage Temperature	-55 °C to +100 °C

**Schematic**

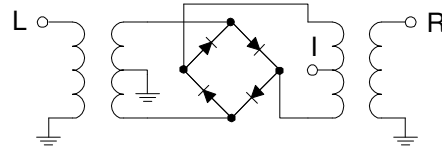

**Outline**

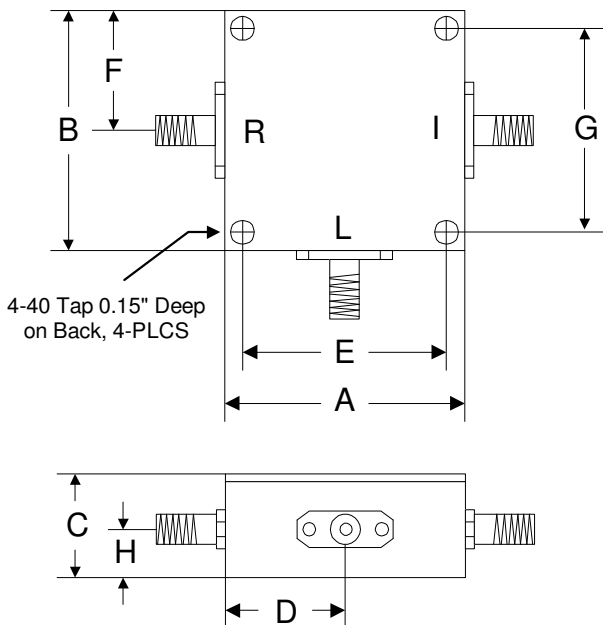

	A	B	C	D	E	F	G	H
<b>Inch</b>	1.250	1.250	0.563	0.625	1.000	0.625	1.000	0.250
<b>mm</b>	31.75	31.75	14.29	15.88	25.40	15.88	25.40	6.35